

2025 GRAND FARM

PARTNERSHIP OPPORTUNITIES

TRANSFORMING AGRICULTURE *through* PARTNERSHIP

GRAND FARM IS A COLLABORATIVE NETWORK of innovators, technologists, growers, educators, and policy makers who collaborate to solve agriculture's biggest challenges. Together, with our partners, we research and develop to collaborate to advance groundbreaking solutions to reshape the agricultural landscape.

We invite you to partner with us to transform agriculture and ensure a future for farming.



**GRAND
FARM**
WWW.GRANDFARM.COM

BECOME A PARTNER. INVEST IN INNOVATION. MAKE AN IMPACT.

Through our global innovation ecosystem, programs, and test plots in North Dakota and Georgia, Grand Farm connects partners to cutting-edge innovation, fostering collaboration among companies, startups, educational institutions, growers, and governments to drive impactful agricultural solutions and accelerate growth.

BASE PARTNERSHIP - \$10,000

Grand Farm is focused on connecting people with problems to those who can help solve them, building collaboration within our ecosystem, and connecting you with our global network of 500+ startups and 2,500+ organizations. As a partner, you'll enjoy the following benefits:

- ▶ **GLOBAL INNOVATION NETWORK:** Connect with top-tier companies, startups, and educational institutions
- ▶ **VENUE DISCOUNTS & ACCESS:** Exclusive access and discounts to Grand Farm's Innovation Shop and the Prairie Den (Fargo)
- ▶ **TARGETED NETWORKING:** Connect with innovative leaders and groups tailored to your interests
- ▶ **BRAND BOOST:** Enhance visibility with logo placements and digital promotions via social media and marketing materials
- ▶ **EXCLUSIVE INVITES:** Special invites to partner-exclusive events and gatherings
- ▶ **PRIORITY EVENT ACCESS:** Receive two free tickets to Grand Farm conferences, our annual 1 Million Thanks event, and prioritized opportunities for speaking engagements

LAND FIRST ACRE - \$5,000* EACH ADDITIONAL ACRE - \$2,000

Grand Farm collaborates with industry corporations, startups, and researchers to develop real-world farm plots. Companies can lease space to demonstrate, research, and validate their technology, products, or practices, with the option of support from Grand Farm's field management team upon request and availability.

CASSELTON, NORTH DAKOTA INNOVATION CAMPUS



Grand Farm's 590-acre Innovation Campus fosters collaboration among growers, industry professionals, and researchers to develop and showcase the latest in agriculture technology.

- ▶ **INNOVATION SHOP:** Grand Farm's 25,000 square foot shop can host groups of up to 300 with customizable spaces and support.
- ▶ **HIGH TRAFFIC:** The Innovation Campus attracts thousands of visitors from around the globe each year.
- ▶ **PTI NORTH DAKOTA:** The North Dakota Precision Technology Institute by Precision Planting operates on 300-acres at the Innovation Campus.

PERRY, GEORGIA UGA GRAND FARM



Grand Farm and the University of Georgia have teamed up to create "UGA Grand Farm," a 250-acre research hub focused on sustainable agriculture using precision tech, robotics, and data analytics.

- ▶ **TECHNOLOGY:** UGA Grand Farm will have pivot and linear irrigation systems for the 2025 growing season.
- ▶ **HIGH TRAFFIC:** Located next to the Georgia National Fairgrounds, the site benefits from over 1 million annual visitors each year.
- ▶ **NEW FACILITY:** A first building is set to open in 2025.

*Availability is limited, and partners must commit by January 1, 2025. Field management services are billed separately, with costs determined by plot protocols. A quote will be provided prior to the start of field management. Services at the Innovation Campus will be overseen by the Grand Farm Fargo team and services at UGA Grand Farm will be overseen by the University of Georgia team.



VENUE RENTAL

Experience the fast-paced agricultural transformation at the Grand Farm Innovation Shop, located in the heart of the Grand Farm Innovation Campus west of Casselton, North Dakota, where growers, startups, corporations, students, researchers, and government converge to forge innovative solutions and explore the high points of agricultural technology.

INNOVATION SHOP TOTAL TAKEOVER - \$2,800/DAY



- ▶ Accommodates up to 500 people
- ▶ Enjoy using the entire building's public spaces
- ▶ Opportunity for amenity requests, such as seating arrangements and vendor assistance
- ▶ Ability to brand the building for the day

AGCOUNTRY FARM CREDIT SERVICES AUDITORIUM - \$2,100/DAY



- ▶ Accommodates up to 300 people
- ▶ Ideal for large events and gatherings
- ▶ Partners can configure the space around their needs
- ▶ Includes large garage doors with easy access to heavy equipment demonstration area

MAPLE RIVER GRAIN & AGRONOMY AMPHITHEATRE AND FARMERS UNION AMPITHEATRE - \$280/DAY



- ▶ Accommodates up to 100 people
- ▶ Ideal for hosting outdoor sessions, including social gatherings and live demonstrations
- ▶ Overlooks the Grand Farm Innovation Campus

COBANK BOARDROOM - \$350/DAY



- ▶ Accommodates up to 14 people
- ▶ Ideal for meetings and presentations

BANKNORTH CLASSROOM - \$350/DAY

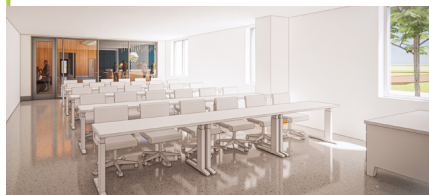

- ▶ Accommodates up to 40 people
- ▶ Ideal for presentations and team trainings

FORUM COMMUNICATIONS FOYER - \$700/DAY



- ▶ Accommodates up to 70 people
- ▶ Ideal for casual social gatherings and happy hours

Partners receive a 30% discount on Grand Farm venue rental pricing. The prices above reflect the 30% discount.

CROSS COLLABORATION

Grand Farm is energized by Emerging Prairie, an organization that drives entrepreneurial and technology-focused initiatives. If you are interested in engaging with our broader initiatives beyond Grand Farm, we would welcome the opportunity to explore those with you.



ENGAGE WITH INNOVATION. BE A PART OF TRANSFORMATIONAL EVENTS IN AGTECH.

Grand Farm's events drive agricultural innovation, bringing together global leaders to showcase the latest in AgTech. These events attract speakers and attendees from across the globe and offer unique opportunities for knowledge sharing, networking, and hands-on experience.

EVENT SPONSORSHIP

BENEFITS	PREMIER \$10,000	GOLD \$7,500	SILVER \$5,000	BRONZE \$2,500
LOGO RECOGNITION AT EVENT(S) AND WITHIN DIGITAL COMMUNICATIONS	X	X	X	X
TICKETS TO THE EVENT AND OUR INVITE-ONLY SPEAKER/SPONSOR DINNER	8	6	4	2
VERBALLY RECOGNIZED AT EVENT	X	X	X	
OPPORTUNITY TO OFFER ATTENDEES PROMOTIONAL MATERIAL AND BRANDED SWAG	X	X		
OPPORTUNITY TO SPEAK OR SERVE ON A PANEL	X			



► **DATE:** June 12th, 2025

► **ATTENDANCE:** 500+ attendees

MISSION: Cultivate Conference brings together a diverse community of experts, thought leaders, entrepreneurs, and growers to share their knowledge and experiences, create feedback loops and explore the exciting possibilities of technology in agriculture.

PRIMARY AUDIENCE: Industry experts and leaders, startups, growers, and curious minds interested in agriculture and technology



► **DATE:** TBD, 2025

► **ATTENDANCE:** 300+ attendees

MISSION: From tackling workforce shortages to eliminating inefficiencies and bridging technology gaps, Autonomous Nation showcases the latest innovations and solutions that will shape the future of our industry.

PRIMARY AUDIENCE: AgTech entrepreneurs, industry experts, and students



► **DATES:** WITHIN CONFERENCES

► **ATTENDANCE:** 75+ attendees per event

MISSION: Hosted at our Innovation Campus facility, Grand Farm Field Days brings together growers, companies, and startups to share and advance AgTech and sustainable practices from seed to harvest.

PRIMARY AUDIENCE: Community members interested in Grand Farm's work, growers, and students

EDUCATIONAL EVENTS

► **DATES:** WITHIN CONFERENCES

► **ATTENDANCE:** 75+ attendees per event

MISSION: Our education events create an inclusive and collaborative ecosystem that meaningfully engages the next generation of agriculturalists by hosting free educational events for K-12 students, teachers, and college students, fostering industry collaboration with educators, and developing mentorship networks with industry experts.

PRIMARY AUDIENCE: Educators, students, and curious minds



GRAND
FARM

BECOME A PARTNER.

Fuel collaboration and innovation across the agricultural value chain in the Grand Farm Ecosystem. Together we're building an inclusive platform, engaging the global Agtech community. Explore our mission at **GRANDFARM.COM** and join us in various ways—from thought leadership and event participation to tech demonstrations—as we create the future of agriculture.



ANDREW JASON

c: (218) 556-2922

e: AndrewJ@grandfarm.com

For any questions, or to confirm your annual partnership,
please contact Andrew Jason at
AndrewJ@grandfarm.com.



GRAND
FARM
WWW.GRANDFARM.COM